

A66 Northern Trans-Pennine Project

Scheme 11: A1(M) Junction 53 Scotch Corner

TR010062

General Scheme Outline Plans

Response to ExA's Procedural Decision PD-006 in Rule 6 Letter

November 2022

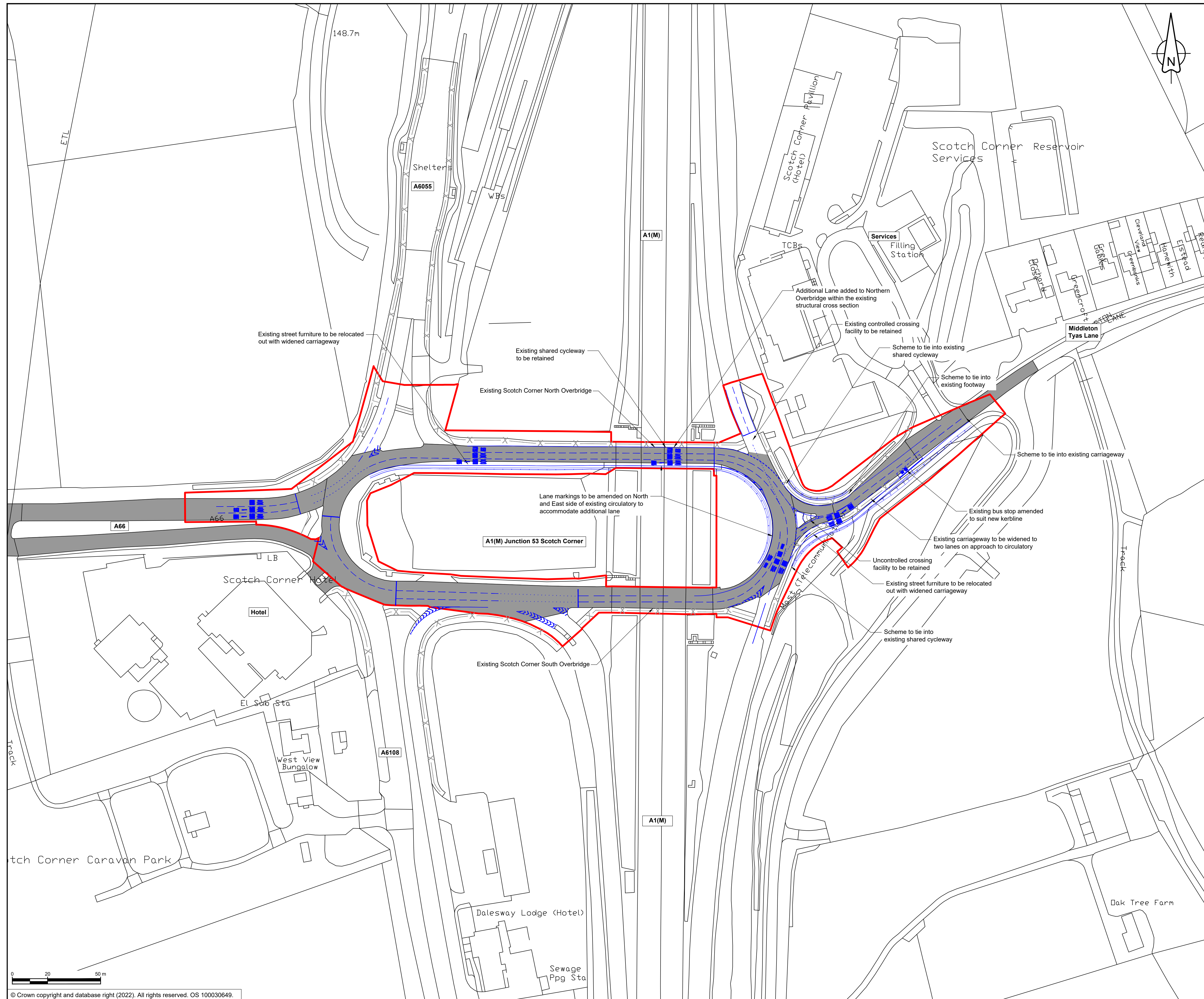

- NOTES**
1. ALL DIMENSIONS ARE IN METRES UNLESS NOTED OTHERWISE.
 2. FOR ENVIRONMENTAL DETAILS REFER TO THE ENVIRONMENTAL MASTERPLAN AND ASSOCIATED DRAWINGS/DOCUMENTS.
 3. THE DESIGN OF THE SCHEME IS SHOWN HERE FOR ILLUSTRATIVE PURPOSES ONLY AND WILL BE SUBJECT TO DETAILED DESIGN DEVELOPMENT IN ACCORDANCE WITH THE PROVISIONS OF THE DEVELOPMENT CONSENT ORDER.
 4. THESE PLANS SHOULD BE READ IN CONJUNCTION WITH RIGHTS OF WAY AND ACCESS PLANS.

- KEY**
- ORDER LIMITS
 - AREA EXCLUDED FROM ORDER LIMITS
 - AREA OF OUTSTANDING NATURAL BEAUTY (AONB)
 - EXISTING WATERCOURSE
 - EXISTING A66 CARRIAGEWAY
 - PARISH BOUNDARY
 - EXISTING PUBLIC RIGHT OF WAY
 - PROPOSED WORKS
 - PROPOSED EARTHWORKS
 - PROPOSED CULVERT & HEADWALL
 - PROPOSED RETAINING STRUCTURE
 - PROPOSED BRIDGE / VIADUCT
 - PROPOSED UNDERPASS / TUNNEL

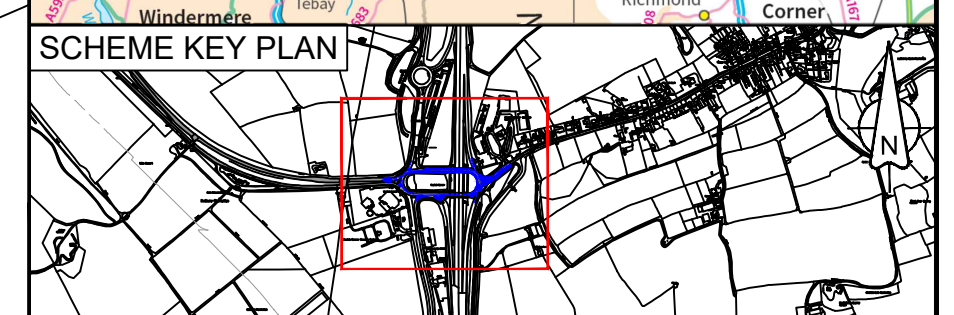
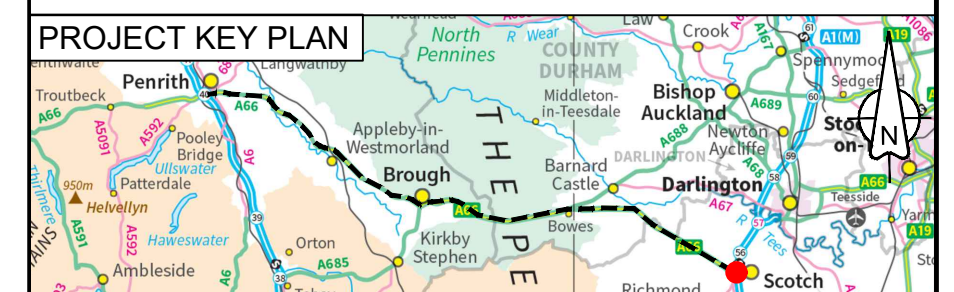

C01	Submitted in response to PD-006				
	SMOR	THAL	TEGG	TEGG	FMOL
	14/11/22	14/11/22	15/11/22	15/11/22	15/11/22
Revision	Revision details				
	Created	Checked	Reviewed	Approved	Authorised
	dd/mm/yy	dd/mm/yy	dd/mm/yy	dd/mm/yy	dd/mm/yy

Purpose
Response to ExA's Procedural Decision PD-006 in Rule 6 Letter

PINS Reference Number
TR010062

Client
3 Piccadilly Place
Manchester
M1 3BN



Project Name / Scheme Name
**A66 Northern Trans-Pennine Project
Scheme 11
A1(M) Junction 53 Scotch Corner**

Drawing Title
**General Scheme Outline Plans
Submitted in response to PD-006
Sheet 1 of 1**

Project Ref. No.	Stage	Scale	@ A1
---	PCF4	1:1000	
		Dimensions	M

Drawing Number	Project	Originator	Volume
HE565627 - AMY - HAC -			
S11	-DR-CH-	900002	
Location	Type	Role	Number

Suitability	Suitability Description	Revision
A	Approved for Stage Complete	C01